

RIKKYO UNIVERSITY

PROSPECTUS



A Liberal Academy

The education of Rikkyo University has been built upon the foundation of liberal arts, going beyond the simple acquisition of intellectual skills. Rikkyo aims to develop the students' power to collaborate with the people of diverse values and beliefs so that we may create to realize a truly human society in the world. Liberal Arts education has recently been evaluated as important and in high demand as globalization continues to impact and shape our lives. Rikkyo seeks to produce the global talent, who may exhibit leadership through the cooperation with other people in the world.

Rikkyo University is an ideal place for students to pursue liberal arts education and empower themselves to explore the unknown territory to be discovered, in which they may gain a new insight and perspective. Rikkyo offers a number of opportunities for students to learn to fulfill their potential, which makes Rikkyo a truly liberal academy.

President's Message

The history of Rikkyo University goes back to the "Rikkyo School," which was established in 1874 by Bishop Channing Moore Williams, a missionary of the American Episcopal Church. In a period when Christianity was severely oppressed, I am sure it must have been an immense hardship to establish a private school to teach Bible studies and English. However, Bishop Williams was convinced that teaching was his mission and chose the path of education even though the demand was so little. Even today, after more than 145 years, his attitude has not been lost. Rikkyo University exists not merely to provide education to meet the demands of society, but to return to society the edifice of knowledge that human beings have accumulated, with the mission to produce graduates who search for universal truth and work for a better world.

Liberal Arts, the core of Rikkyo's educational policy, should not be understood as a mere general education. It is the sort of education that values the pursuit of ideals which have yet to be achieved in the long history of humanity. In other words, it is the education that discusses dreams and makes them visible. I think that Rikkyo University has to be a "risky" place in a sense, in order to embody the authentic liberal arts education inherited from the Western tradition. We must continue our quest for the truth without the fear of criticizing and being criticized. We must be skeptical toward common sense, theories, and authority; we must analyze and relativize them, critically examining original sources and their broader relations. From time to time, you may encounter obstacles and your ideas may be rejected. During these times, I want you to challenge yourself to reconstitute your ideas, no matter how difficult it may be, and to gain the skills to analyze, communicate, and improve upon the world around you.

Rikkyo University is preparing to reaffirm its roots and strengthen its distinctive practices, in which Rikkyo's spirit of foundation and philosophy of education has been reflected. Especially in light of reforms such as the enrichment of the introduction phase education and leadership education, the development of the university-wide Rikkyo minor program, and the reinvigoration of service learning, student volunteering, and community engagement, I am confident that we will be able to provide the best environment for the exploration of truth.

Since 2020, there is no doubt that the coronavirus pandemic has had a serious impact on people. Under these circumstances, I would like you to consider the world in the face of hardship and think about the future. It is my sincere hope that all the students may grow up to construct a new world through their studies at Rikkyo University.



Renta Nishihara
President
Rikkyo University

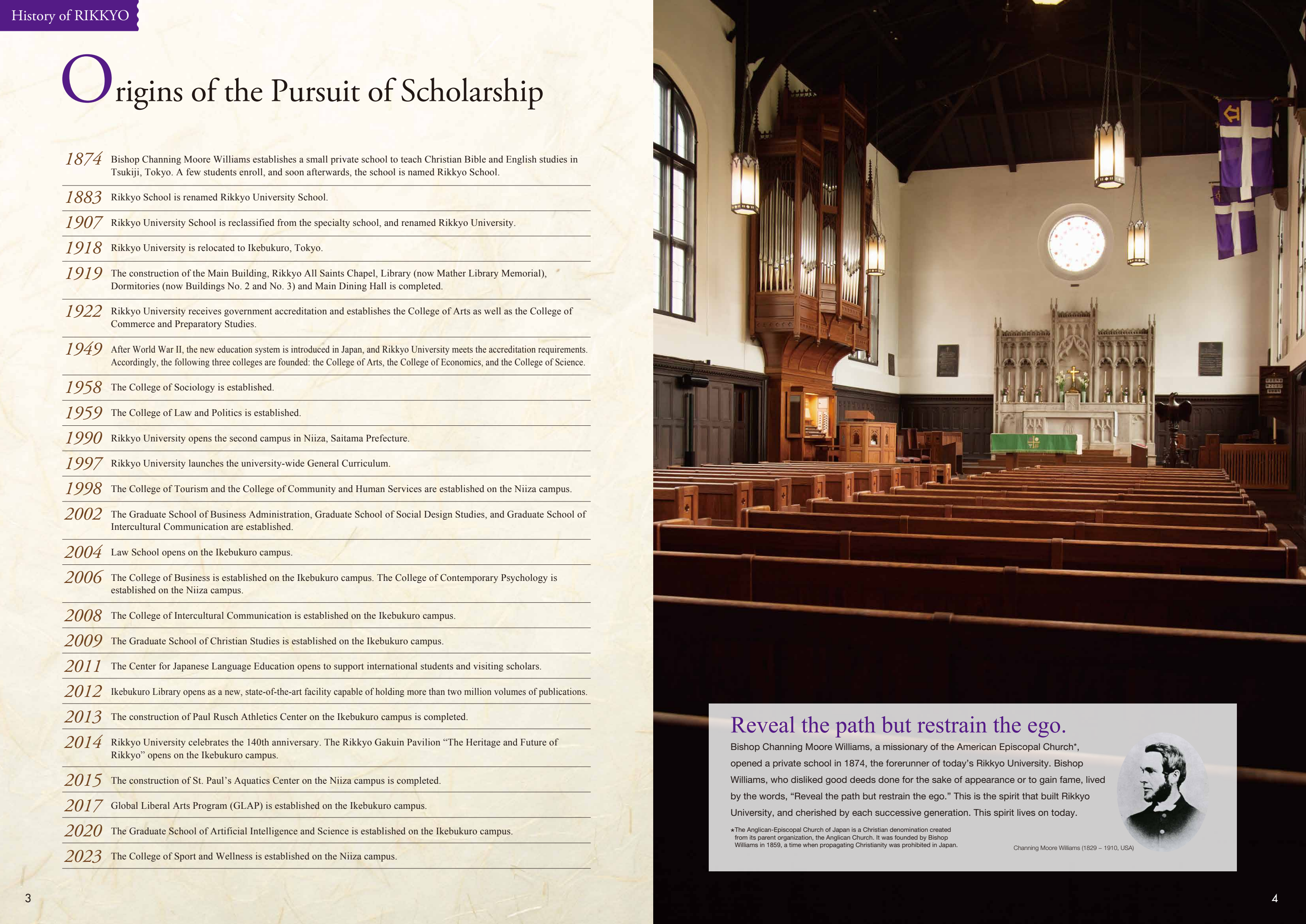

Origins of the Pursuit of Scholarship

- 1874

Bishop Channing Moore Williams establishes a small private school to teach Christian Bible and English studies in Tsukiji, Tokyo. A few students enroll, and soon afterwards, the school is named Rikkyo School.
- 1883

Rikkyo School is renamed Rikkyo University School.
- 1907

Rikkyo University School is reclassified from the specialty school, and renamed Rikkyo University.
- 1918

Rikkyo University is relocated to Ikebukuro, Tokyo.
- 1919

The construction of the Main Building, Rikkyo All Saints Chapel, Library (now Mather Library Memorial), Dormitories (now Buildings No. 2 and No. 3) and Main Dining Hall is completed.
- 1922

Rikkyo University receives government accreditation and establishes the College of Arts as well as the College of Commerce and Preparatory Studies.
- 1949

After World War II, the new education system is introduced in Japan, and Rikkyo University meets the accreditation requirements. Accordingly, the following three colleges are founded: the College of Arts, the College of Economics, and the College of Science.
- 1958

The College of Sociology is established.
- 1959

The College of Law and Politics is established.
- 1990

Rikkyo University opens the second campus in Niiza, Saitama Prefecture.
- 1997

Rikkyo University launches the university-wide General Curriculum.
- 1998

The College of Tourism and the College of Community and Human Services are established on the Niiza campus.
- 2002

The Graduate School of Business Administration, Graduate School of Social Design Studies, and Graduate School of Intercultural Communication are established.
- 2004

Law School opens on the Ikebukuro campus.
- 2006

The College of Business is established on the Ikebukuro campus. The College of Contemporary Psychology is established on the Niiza campus.
- 2008

The College of Intercultural Communication is established on the Ikebukuro campus.
- 2009

The Graduate School of Christian Studies is established on the Ikebukuro campus.
- 2011

The Center for Japanese Language Education opens to support international students and visiting scholars.
- 2012

Ikebukuro Library opens as a new, state-of-the-art facility capable of holding more than two million volumes of publications.
- 2013

The construction of Paul Rusch Athletics Center on the Ikebukuro campus is completed.
- 2014

Rikkyo University celebrates the 140th anniversary. The Rikkyo Gakuin Pavilion “The Heritage and Future of Rikkyo” opens on the Ikebukuro campus.
- 2015

The construction of St. Paul’s Aquatics Center on the Niiza campus is completed.
- 2017

Global Liberal Arts Program (GLAP) is established on the Ikebukuro campus.
- 2020

The Graduate School of Artificial Intelligence and Science is established on the Ikebukuro campus.
- 2023

The College of Sport and Wellness is established on the Niiza campus.

Reveal the path but restrain the ego.

Bishop Channing Moore Williams, a missionary of the American Episcopal Church*, opened a private school in 1874, the forerunner of today’s Rikkyo University. Bishop Williams, who disliked good deeds done for the sake of appearance or to gain fame, lived by the words, “Reveal the path but restrain the ego.” This is the spirit that built Rikkyo University, and cherished by each successive generation. This spirit lives on today.

*The Anglican-Episcopal Church of Japan is a Christian denomination created from its parent organization, the Anglican Church. It was founded by Bishop Williams in 1859, a time when propagating Christianity was prohibited in Japan.

Channing Moore Williams (1829 – 1910, USA)



Academic Calendar



| | |
|------------------|--|
| <i>April</i> | Entrance Ceremony (Spring) New Student Orientation Start of Spring Semester Classes |
| <i>May</i> | Foundation Day Foundation Anniversary Ceremony |
| <i>July</i> | End of Spring Semester / Final Exams |
| <i>August</i> | Summer Vacation |
| <i>September</i> | Degree Conferral Ceremony for Graduate Schools and Special Commencement (for the Colleges) Entrance Ceremony (Fall) New Student Orientation Start of Fall Semester Classes |
| <i>October</i> | Sports Fair |
| <i>November</i> | St. Paul's Festival (Ikebukuro campus School Festival) IVY Festa (Niiza campus School Festival) |
| <i>December</i> | Bishop Williams Memorial Day Christmas Week Winter Recess |
| <i>January</i> | End of Fall Semester / Final Exams |
| <i>February</i> | Entrance Exam |
| <i>March</i> | Degree Conferral Ceremony for Graduate Schools Graduation Service, Graduation Ceremony (for Colleges) |

Key Statistics

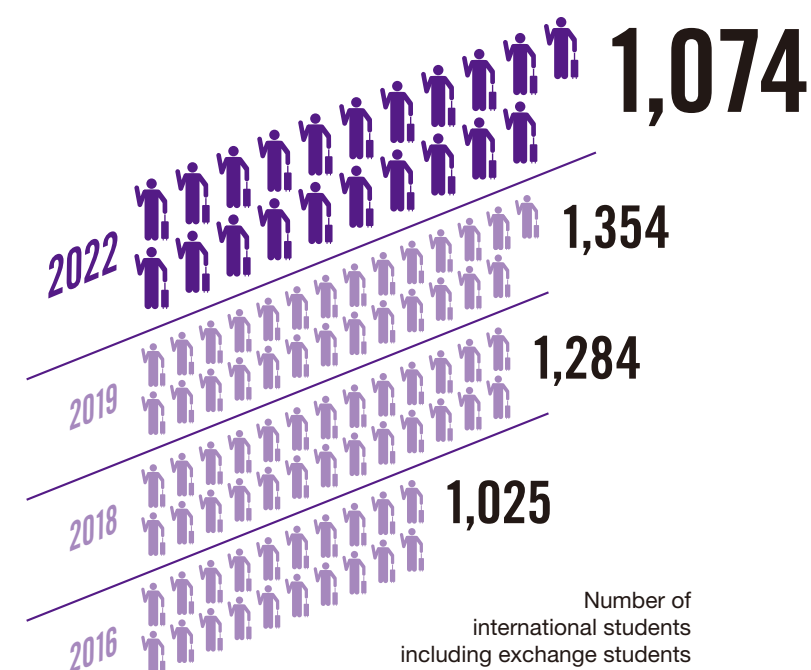
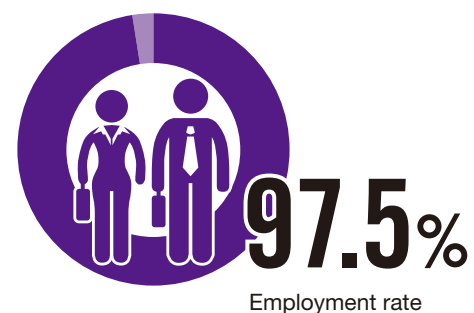
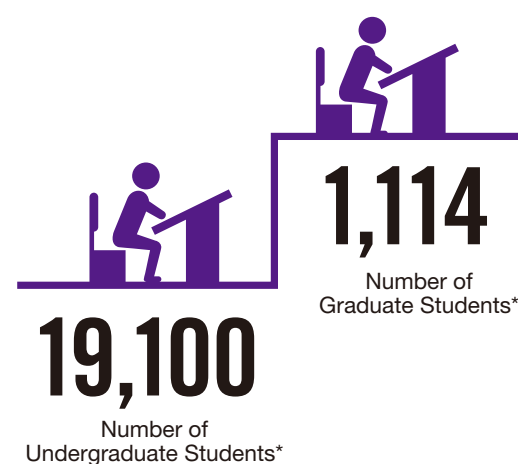

Q How did you come to choose Rikkyo University?

I came to Rikkyo University because I wanted to study in Japan. Rikkyo University was one of my top choices because of a few reasons. Firstly, it is located very conveniently in the urban area of Tokyo. It also has great support for translation and interpretation, which is what I wanted to do before coming here. I was worried about the entrance test at first but the PEACE program and the way admissions were conducted made it smooth and easy to start my school life in Rikkyo.

Q What are you studying now?

I am in the College of Intercultural Communication so my studies are mainly related to cultures, languages and global issues. However in Rikkyo we are relatively free to choose whatever we would like to study, including courses from other colleges. Therefore I am also studying courses from other colleges like Contract Law and Tourism Studies. For foreign students, there are also Japanese classes that are catered to my level and they help me achieve more in the university environment.

Q How is your university life?

Other than going to my many different classes, I also participate in a variety of extra-curricular activities which is where I spend most of my time right now. I joined the scuba diving club where we go on diving trips during

holidays, it is something I have never done before so it is very exciting. I also enjoy singing in the choir, we do multiple performances each year and have a wide selection of repertoire ranging from classical Latin chants to J-pop arrangements. When I am outside school, I work about three days a week at a digital art museum, it is not easy balancing all these activities and study but I think it is extremely rewarding. Tokyo is a city with countless places to visit so I think you will never run out of things to do.

Q What plans do you have for your future?

I plan to pursue a career in Japan. I like the country and would like to consider staying here for a long time. Since I can speak multiple languages, I would like work in an industry that can allow me to utilize that strength, such as translation and interpretation.

Q What do you find most appealing about Rikkyo?

There's lots of things to like here but I like the campus the most. Not only is it beautiful it is also compact and convenient. Most places around the campus are perfect for studying and reading. Recently I really enjoy going to the library which is spacious, fitted with lots of glass and full of studying students. It also helps that the campus is readily accessible and is very close to the center of Ikebukuro, so there's no shortage of restaurants and cafes to go to.

Q How did you come to choose Rikkyo University?

My major in my undergraduate study was international business, where I first learned about the unique characteristics of the Japanese business environment. I wanted to learn more and have therefore applied for an exchange semester in Japan at Rikkyo University offered by my home university. Choosing Rikkyo was not hard, as I really liked the classes that were offered, dormitories, location of the campus and the Japanese language program. This decision completely changed my life. Here I am, 4 years later, again at Rikkyo.

Q What are you studying now?

Currently, I am a graduate student at Rikkyo in the Master's in International Business Program. The program offers a lot of electives that are very diversified and offer deeper knowledge in many areas of International Business. I have learned a lot through the courses and gained theoretical as well as practical knowledge. The classes are small what enables the professors to really offer tailored advice and knowledge to each student. The different teaching and grading styles enable students to choose subjects that suit their style of studying the most.

Q How is your university life?

Besides taking interesting classes in my major, I am also taking Japanese language classes. Currently, I have an internship at Bosch in Tokyo, so on some days I work from home or university. This sounds like a lot of work, but my university life is never boring. Outside of classes I like to explore the city with my friends and often go for a day or two-day trip. There are also more vacations than in my home country where I can travel around Japan. There are many different options to join clubs or circles where it is easy to meet and connect with Japanese students as well.

Q What plans do you have for your future?

Originally, I wanted to return to Europe, but I have now changed my mind. As I am a business major, my biggest dream would be to start my own company. For that you really need to understand the market what leaves me with two options, Japan, and my home country. I have really learned a lot about the Japanese business environment at Rikkyo and therefore feel prepared to stay in Japan and try my luck.

Q What do you find most appealing about Rikkyo?

This is hard to answer. From the perspective of classes I would say the best is the connections you can build with other students and professors in the classes. The classes really prepare you for your future work, as you gain a lot of practical and theoretical knowledge in many different areas of international business. I also really loved the intense Japanese classes that have helped my Japanese level to advance fast, what is especially important, if I want to work and live in Japan. University helps find job and internship opportunities. Outside of classes, I loved the selection of clubs and circles. Another thing I really love is the beautiful view of the city offered from some university buildings. The university itself is very beautiful and has an amazing atmosphere, especially around Christmas and other holidays.

Kwok Kit Edward Wong

From Hong Kong, China

Undergraduate Student,
Department of Intercultural Communication,
College of Intercultural Communication

Neza Sluga

From Slovenia

Graduate Student,
Master's in International Business,
Graduate School of Business

Campus Life Support



Since its foundation, Rikkyo University has been one of the prestigious and leading private universities in Japan with a student body of approximately 20,000 which includes over 1,100 international students from around the globe. Rikkyo provides a premier educational opportunity and meticulous student support services at its two campuses in Ikebukuro and Niiza.

Support for International Students

International Office provides supports for international students in admissions, registration of courses, accommodations, scholarship opportunities, health insurance, immigration, and other such related needs. For newly admitted students, International Office organizes the buddy system, in which Rikkyo students volunteer to help them adjust smoothly to campus life. International Office also operates the Global Lounge, where a number of events and activities are organized throughout the year with the assistance from international students and Rikkyo students.

Accommodations

Rikkyo University operates off-campus international dormitories in Tokyo and Saitama. The dormitories offer single-unit, furnished rooms. An optional meal plan and a bedding rental service are available with additional fees. Dormitory managers are available on site to support the residents.

Japanese Language Program

Center for Japanese Language Education (CJLE) is the home of our Japanese Language Program and also offers various programs to support all the international students who study at Rikkyo University. Besides the Japanese language classes, CJLE provides many kinds of support for the language learning process both in and outside of the classroom. CJLE also offers the credit-bearing Short-Term Intensive Japanese Program for the students who would like to stay and study for a few weeks at Rikkyo in summer and/or winter.

Career Support

Career Center conducts several career support programs, providing students with assistance in their job search. For international students, Career Center and International Office hold a joint seminar on job searching for international students and also a panel discussion that focuses on how to be successful in their job search as an international student.



Colleges & Majors

Through 11 colleges, 27 departments, 8 disciplines, and 1 program, Rikkyo University undergraduate curriculum aims to educate the whole personality, based on the spirit of Liberal Arts and the pursuit of specialization.

Arts

- Christian Studies
- Letters
(English and American Literature, German Literature, French Literature, Japanese Literature, Philosophy and Creative Writing)
- History
(World History, Japanese History, Interdisciplinary Cultural Studies)
- Education
(Educational Studies, Primary Education)

Intercultural Communication

- Intercultural Communication

Economics

- Economics
- Economic Policy Studies
- Accounting and Finance

Business

- Business • Global Business

Science

- Mathematics • Physics
- Chemistry • Life Science

Sociology

- Sociology
- Contemporary Culture and Society
- Communication and Media Studies

Law and Politics

- Law • International Business Law
- Politics

Tourism

- Tourism and Hospitality Management
- Culture and Tourism Studies

Community and Human Services

- Community Development
- Social Work

Contemporary Psychology

- Psychology
- Body Expression and Cinematic Arts

Sport and Wellness

- Sport and Wellness

Global Liberal Arts Program

- Global Liberal Arts Program

Graduate Programs

With 15 graduate schools and 28 graduate degree programs, Rikkyo University aims to promote both leading-edge academic research and the nurturing of highly skilled professionals.

Christian Studies

- Christian Studies

Arts

- Japanese Literature
- English and American Literature
- German Literature
- French Literature
- History
- Interdisciplinary Cultural Studies
- Education
- Comparative Civilizations

Intercultural Communication

- Intercultural Communication

Economics

- Economics

Business

- Business
- International Business

Science

- Physics
- Chemistry
- Mathematics
- Life Science

Sociology

- Sociology

Law and Politics

- Law and Politics

Tourism

- Tourism

Community and Human Services

- Community and Human Services

Contemporary Psychology

- Psychology
- Clinical Psychology
- Body Expression and Cinematic Arts

Sport and Wellness

- Sport and Wellness

Business Administration

- Business Administration

Social Design Studies

- Business Administration in Network and Social Organization

Artificial Intelligence and Science

- Artificial Intelligence and Science

Global Liberal Arts Program (GLAP)

Global Liberal Arts Program (GLAP), which was launched in 2017, is a selective program in order to cultivate global-minded leaders for the future. The students will take a variety of courses in liberal arts that are entirely taught in English. They will receive a Bachelor of Arts after successful completion. One of the program's highlights is its class size. Each year, only 30 students are admitted on a rigorous standard and are expected to be actively engaged in academic activities with instructors and international students.

As a part of its curriculum, for one year from the fall semester of the second year to the spring semester of the third year, all GLAP students undertake study abroad at a liberal arts college outside Japan, encountering other cultures and cultivating the skills required to play an active role beyond borders. When they come back to Rikkyo, they will continue their studies, while specializing in one of the three academic disciplines: Humanities, Citizenship, or Business.

During their studies at Rikkyo, the students are exposed to a number of opportunities to interact with international students on campus. There is an option for them to choose to live at one of the Rikkyo's international dormitories, where a number of exchange students live.

Research Centers and Institutes

Rikkyo University provides knowledge for next-generation learning and for advancing high-level research across a diverse range of fields, necessitated by an increasingly information-driven and globalized world,

- The Institute for American Studies
- Japan Institute of Christian Education of Rikkyo (St. Paul's) University
- Rikkyo Institute of Church Music
- Rikkyo Institute of Japanese Studies
- The Institute for Latin American Studies
- RIKKYO UNIVERSITY Institute of Social Welfare
- Rikkyo Research Institute of Wellness

- Rikkyo Institute for Business Law Studies
- Institute for Tourism
- Centre for Asian Area Studies
- Rikkyo Institute for Global Urban Studies
- Research Center for Education for Sustainable Development
- St. Paul's Institute of English Language Education
- Rikkyo Institute for Social Design Studies

- Institute of Community and Human Service, Rikkyo University
- Rikkyo Archives
- Institute for Leadership Studies
- Edogawa Rampo Memorial Center for Popular Culture Studies, Rikkyo University
- Rikkyo Institute of Economics
- Rikkyo Institute for Peace and Community Studies
- Rikkyo Gender Forum

- Research Center for Measurement in Advanced Science
- Rikkyo Research Center for Cooperative Civil Societies
- Research Center for Smart Molecules
- Research Center for Mathematical Physics
- Rikkyo Research Institute for Advanced Research in the Psychology, Arts and Humanities
- Research Center for Life Science



Christopher T. Keaveney

Professor
Global Liberal Arts Program

Everybody Has Something to Say

Every individual has something to say, and the desire—the need—to express oneself is an important dimension of what it means to be human. I have always been passionate about artistic expression and the forms that it takes, whether it be literature, film, music, or the visual arts. I am a published poet, and my scholarship encompasses comparative literature and Japanese cultural studies. At Rikkyo University, I am a faculty member in the Global Liberal Arts Program, but I also teach courses in the Department of Letters.

My publications include books about comparative literature, Japanese culture and baseball, and Western rock musicians and Japan. My current research revolves around *kanshi*, poems in Classical Chinese by Japanese writers. Specifically, I look at the *kanshi* written by creative writers in Japan from The Meiji period to the Reiwa period, and I seek to understand why Japanese writers have been drawn to this challenging practice of composing poetry in a language other than their own.

In fact, fostering strong communication skills is one of the central objectives of the Global Liberal Arts Program’s curriculum, which is conducted entirely in English, and



students are required to deliver presentations and to participate in group discussions and collaborative projects. Students are encouraged to find their own unique voice and to express their views effectively.

In my courses, students engage with literary texts and other forms of creative expression to consider larger global issues and human concerns. For example, in my course Literature of War and Peace, we read works of

literature from ancient to contemporary times and from around the world—from ancient Greece to contemporary Rwanda—to understand how writers have wrestled with themes related to war, peace, and reconciliation. My classes are enlivened by a diverse student body who bring a variety of perspectives to our discussions. I hope that you will join us!



I am an urban economist, who uses economic methods to analyze issues that arise in cities. This is an interesting academic field because, in the modern world, so many activities including the production and consumption of goods and services and the exchange of ideas and knowledge, take place in cities. Therefore, understanding the dynamics of cities means a lot to understand our society.

Tokyo is the largest urban agglomeration in the world. In addition, Ikebukuro, the neighborhood in which Rikkyo University’s campus is located, is the transportation hub and cross-cultural point of the Tokyo Metropolitan area. Analyzing cities in this dynamic area has been an exciting experience for myself as well as my students since I started teaching at Rikkyo in 2006.

I majored in landscape planning in Japan as an undergraduate student and practiced it for a few years. Then, I decided to do graduate study in economics in the United States. Looking back, studying different fields in different countries was an especially interesting part of my journey, because I was able to notice that academic disciplines themselves are based on the culture and customs of the society in which they were nurtured. My experience also allowed me to acquire two lenses to observe objects. These lenses have different focal points; therefore, I can look at my research objects in greater depth.

I am looking forward to studying cities with students with different cultural and disciplinary backgrounds at Rikkyo University’s campus. With a diverse level of Japanese language courses and a variety of courses taught in Japanese and English, you are encouraged both to study further your own specialization and to explore new academic fields.

We are looking forward to welcoming you at our warm and friendly community in the midst of the big city.



Kayo Tajima

Professor
Department of Economic Policy Studies
College of Economics



Academic Collaboration with the World

Rikkyo University is rapidly expanding its global network through a variety of study abroad programs and student exchanges as well as research activities with top-ranked institutions worldwide. Rikkyo’s active cooperation with overseas partners empowers students to excel on the global stage and creates a more culturally diverse campus by welcoming international students from around the world.

Colored ●, ■, ★ marks on the map represent different departments and programs.

● Inter-University Programs (open to all students)

■ Arts

■ Graduate School of Christian Studies

■ Intercultural Communication

■ Economics

■ Business

■ Science

■ Sociology

■ Law and Politics

■ Tourism

■ Community and Human Services

■ Contemporary Psychology

■ Global Liberal Arts Program (GLAP)

■ ACE Program

★ Linkage

★ Research Center and Institutes

North America

Canada

- British Columbia Institute of Technology
- Douglas College
- HEC Montreal
- Memorial University of Newfoundland
- Queens University at Kingston
- Saint Mary’s University
- St. Thomas University
- University of Lethbridge
- University of New Brunswick
- University of Quebec at Montreal
- University of Sherbrooke
- University of the Fraser Valley
- University of Victoria

U.S.A.

- Arkansas State University
- Augustana College
- Austin Peay State University
- Beloit College
- California Polytechnic State University, San Luis Obispo
- California State University, San Marcos
- Clemson University
- City University of New York
- Columbia University
- Eastern Kentucky University
- Emory & Henry College
- Jacksonville University
- Kansas State University
- Kent State University
- Kenyon College
- Linfield University
- Louisiana State University and Agricultural & Mechanical College
- Mercy University
- Millikin University
- Montana State University
- Moravian University
- Nazareth College
- Northeastern Illinois University
- Northeastern University
- Northern Arizona University
- Pacific University
- Presbyterian College
- Randolph-Macon College
- Rider University
- San Diego State University
- Seton Hall University
- State University of New York Geneseo
- St. Cloud State University
- Stockton University
- Texas State University, San Marcos
- The Ohio State University
- The University of Chicago
- The University of New Mexico
- The University of the South
- The University of Toledo
- The University of Vermont
- The University of West Alabama
- Trinity College
- Trinity University
- University of California, Santa Cruz
- University of Central Florida

- University of Central Oklahoma
- University of Dallas
- University of Denver
- University of Hawaii at Hilo
- University of Hawaii at Manoa
- University of Houston
- University of Missouri, St. Louis
- University of Oregon
- University of Tennessee at Chattanooga
- University of Virginia
- University of Washington
- University of West Florida
- Virginia Wesleyan University
- Western Michigan University
- Wittenberg University

Latin America

Brazil

- University of São Paulo

Mexico

- Monterrey Institute of Technology

Europe and Middle East

Austria

- University of Innsbruck

Belgium

- Catholic University of Leuven
- Université Saint-Louis Bruxelles

Czech Republic

- Anglo-American University
- Charles University
- Masaryk University

Denmark

- Aarhus University
- Copenhagen Business School
- Roskilde University

Finland

- Hanken School of Economics
- Tampere University
- University of Turku
- University of Eastern Finland

France

- EDHEC Business School
- ESCEM School of Business
- IESEG School of Management
- INALCO
- Jean Moulin University Lyon 3
- NEOMA Business School
- Panthéon-Assas University (Paris 2)
- University of Gustave Eiffel
- University of Orleans
- University of Paris

Germany

- Bergische University of Wuppertal
- Cologne Business School
- EBS Business School
- Humboldt University of Berlin
- Osnabrück University
- University of Bonn
- University of Cologne
- University of Erlangen-Nurnberg
- University of Frankfurt
- University of Marburg
- University of Tübingen

Greece

- American College of Greece

Hungary

- Eotvos Lorand University

Ireland

- Dublin City University

Israel

- Tel Aviv University

Italy

- John Cabot University
- University of Bologna
- Università degli Studi Internazionali di Roma
- University of Verona

Netherlands

- Leiden University
- Leiden University College the Hague
- Radboud University Nijmegen
- Rotterdam Erasmus University
- University College Utrecht
- University of Twente
- ZUYD University of Applied Sciences

Norway

- BI Norwegian School of Management
- Norwegian School of Economics and Business Administration, NHH
- University of Agder
- Volda University College

Poland

- SWPS University of Social Sciences and Humanities
- University of Warsaw

Slovenia

- University of Ljubljana

Spain

- Abat Oliba CEU University
- Autonomous University of Barcelona
- University of Alicante
- University of Leon
- University of Salamanca

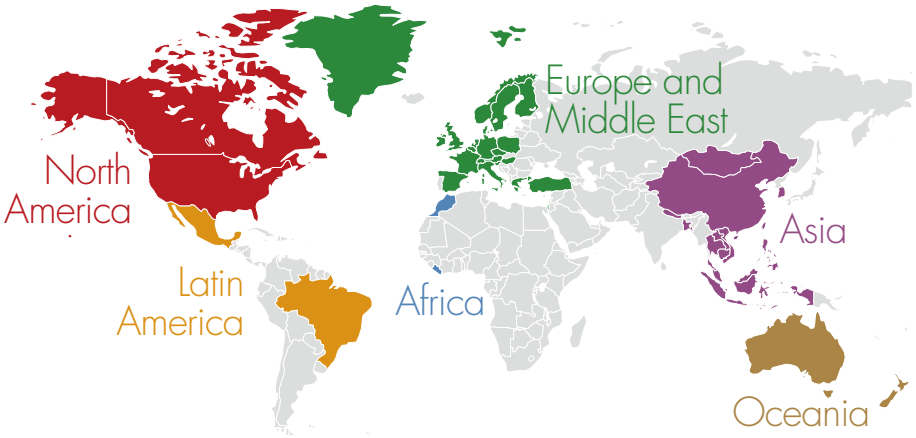

- University of Seville
- University of the Basque Country

Sweden

- Lund University
- Örebro University
- Uppsala University

Switzerland

- Eastern Switzerland University of Applied Sciences
- Zurich University of Applied Sciences

Turkey

- Sabancı University

United Kingdom

- Aberystwyth University
- Keele University
- The University of Manchester
- University of Cambridge
- University of Chichester
- University of Essex
- University of Lincoln
- University of Liverpool
- University of Sheffield
- University of Stirling
- University of Sussex
- York St John University

Africa

Liberia

- Cuttington University

Morocco

- ISCAE

Asia

Brunei

- University of Brunei Darussalam

Bangladesh

- BRAC
- BRAC University
- The Grameen Bank
- University of Dhaka

Cambodia

- Cambodian Mekong University

China

- Beijing Foreign Studies University
- Beijing Normal University
- Chinese Academy of Sciences
- Chinese Academy of Social Sciences

Singapore

- Nanyang Technological University
- National University of Singapore
- Singapore Management University

Taiwan, R.O.C.

- Chang Gung University
- Fu Jen Catholic University
- National Cheng Kung University
- National Chengchi University
- National Dong Hwa University
- National Taipei University
- National Taiwan Normal University
- St. John's University
- Wenzao Ursuline University of Languages

Thailand

- Chiang Mai University
- Chulalongkorn University
- Population and Community Development Association (PDA)
- Thammasat University

Vietnam

- Foreign Trade University
- RMIT Vietnam
- University of Social Sciences and Humanities, Vietnam National University-Hanoi
- University of Social Sciences and Humanities, Vietnam National University-Ho Chi Minh

Oceania

Australia

- Curtin University
- Deakin University
- Edith Cowan University
- LaTrobe University
- Macquarie University
- Monash University
- Murdoch University
- Queensland University of Technology
- RMIT Australia
- The University of Sydney
- University of New South Wales
- University of South Australia

New Zealand

- Victoria University of Wellington

As of October, 2023

Global Networks

AALAU

(Alliance of Asian Liberal Arts Universities)

AALAU consists of leading universities in Asia (e.g.Hong Kong, China, Taiwan, Japan, South Korea, and India) that put emphasis on liberal arts for their education.

CUAC

(Colleges and Universities of the Anglican Communion)

There are more than 120 institutions of higher education connected to the CUAC throughout the world, and they are a great support as Rikkyo University moves toward internationalization.

Overseas Offices

Asia

Hong Kong, China
Shanghai, China
Jakarta, Indonesia

North America

Los Angeles, USA
New York, USA

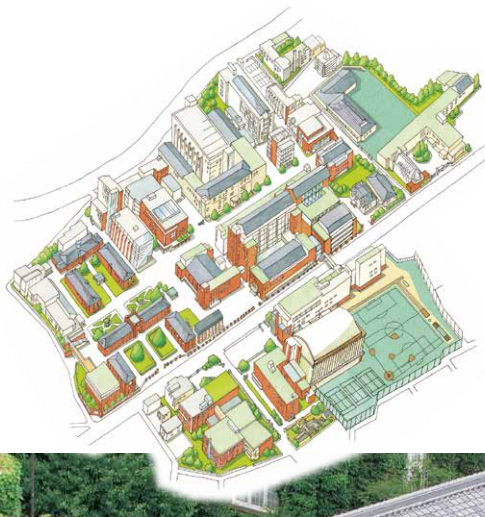

Ikebukuro Campus

Tokyo



Tokyo Metropolitan-Nominated Historical Building

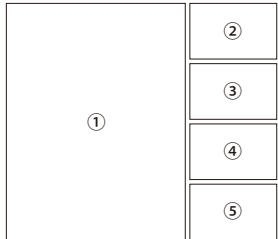

①Main Building (Building No.1, Morris Hall)
The Main Building is the symbol of Rikkyo University. Built in 1918, it is one of the oldest buildings on campus and is used even today for classrooms, as it has been used for almost a century.

②Tucker Hall
Tucker Hall auditorium was built in memory of Bishop Henry St. George Tucker, an early university president responsible for much of the growth and expansion of the school. The auditorium can hold more than one thousand people.

③Ikebukuro Library
The Ikebukuro Library is one of the largest university libraries in Japan, providing space for two million books and 1,520 seats for patrons. The facility includes study rooms, the Learning Square, and break rooms.



④Global Lounge
The Global Lounge is for students, both Rikkyo and visiting international students, who are interested in study abroad and cross-cultural exchange. Niiza Campus, Global Lounge is located in Building 8.

⑤The Prayer Room
The Prayer Room, located on the 3rd floor of McKim Hall (Building No.15) on the Ikebukuro campus, is a unit-type prayer room that combines the Japanese sense of hospitality with Japanese spatial design. The Prayer Room is a multi-faith prayer room that can be used by anyone, regardless of their religion.

Undergraduate Programs

- Arts
- Intercultural Communication
- Economics
- Business
- Science
- Sociology
- Law and Politics
- Global Liberal Arts Program

Graduate Programs

- Christian Studies
- Arts
- Intercultural Communication
- Economics
- Business
- Science
- Sociology
- Law and Politics
- Business Administration
- Social Design Studies
- Artificial Intelligence and Science

Undergraduate Programs

- Tourism
- Community and Human Services
- Contemporary Psychology
- Sport and Wellness

Graduate Programs

- Tourism
- Community and Human Services
- Contemporary Psychology
- Sport and Wellness

Locations at the heart of Japan

The main campus of Rikkyo University is located in Ikebukuro, which is one of the major hubs in Tokyo and provides an easy access to train stations such as Shinjuku, Shibuya, Tokyo, Akihabara, and others.



Niiza Campus

Saitama

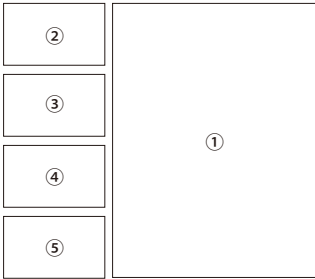
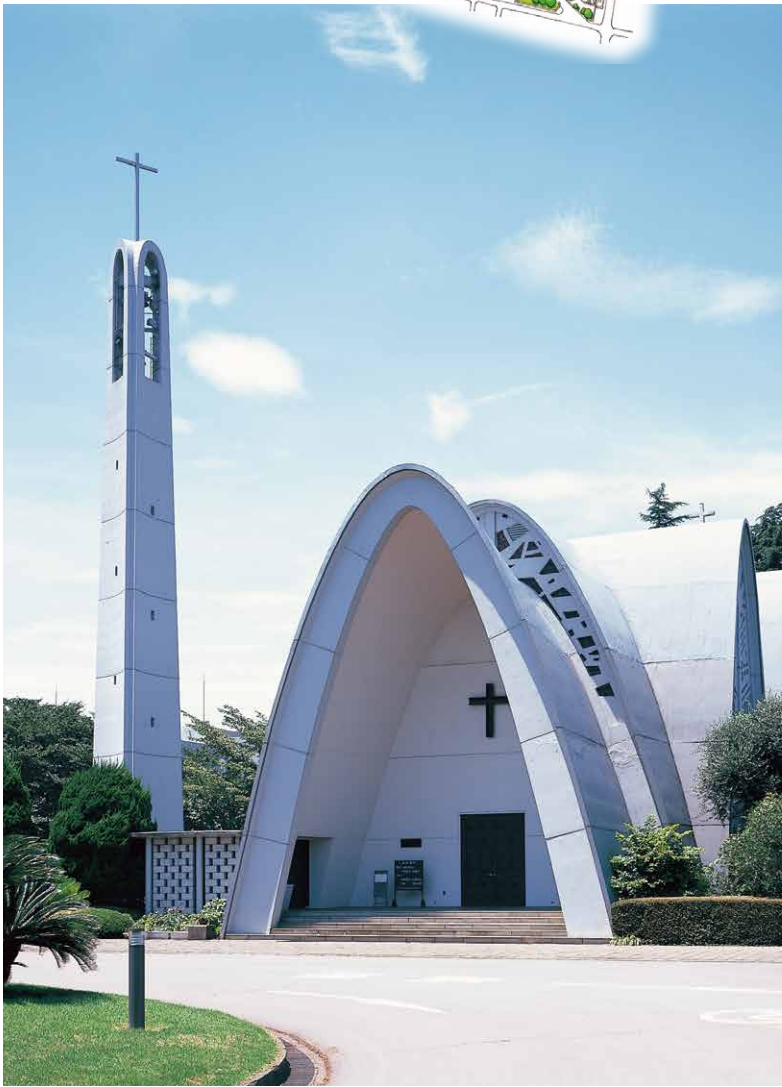

①Rikkyo St. Paul's Chapel
The unique arches create a truly beautiful exterior for this chapel. The bell tower next door is 31 meters high and tolls to signal the beginning of worship services.

②Building No.1
The symbol of the Niiza campus. Home to a large lecture hall, Career Center, Health Center, Information Lounge, a convenience store and the Bookstore.

③Niiza Library
The Niiza Library that houses a vast collection of 260,000 books and documents. Specializing in tourism, community and human services, psychology, body expression and cinematic arts.

④Shiori (Niiza Library Learning Commons)
The Niiza Library Learning Commons, called Shiori, is located on the 2nd floor of the Niiza Library and offers a space equipped with group study rooms, multi-purpose studios, and other facilities for active learning.

⑤Building No.7
Administrative Student Services, International Office, Volunteer Center, Certification Courses Office, and Students with Disabilities Support Office are all located here under the same roof.



創立150周年ビジョン



立教大学
RIKKYO UNIVERSITY

RIKKYO UNIVERSITY

english.rikkyo.ac.jp



Ikebukuro Campus

3-34-1 Nishi-Ikebukuro, Toshima-ku, Tokyo 171-8501, Japan

Niiza Campus

1-2-26 Kitano, Niiza-shi, Saitama 352-8558, Japan